

环境特性:

1. 储存温度: -40°C~+85°C相对湿度<80%.
2. 工作温度: -40°C~+85°C

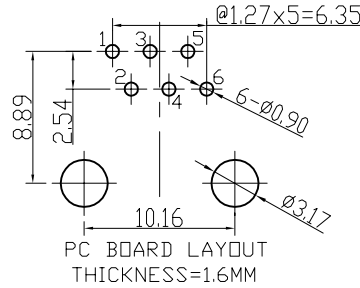
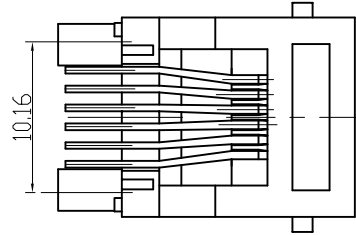

机构特性:

1. 塑壳材质: PBT, UL94V-0;
2. 圆针材质: 磷青铜, $\varnothing 0.46\text{mm}$
3. 圆针电镀: 镍底, 表面全部镀金;
4. 插入/拔出力: 30N Max.
5. 配合强度: 50N for 60s \pm 5s.
6. 使用寿命: 最少750次插拔.

REV. 版本	ECN NO. 变更说明	DATE 日期
01	ADD P/N	2008.07.19
02-06	ADD P/N	2015.08.25

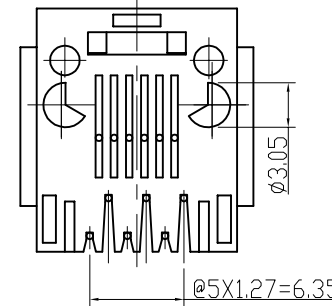
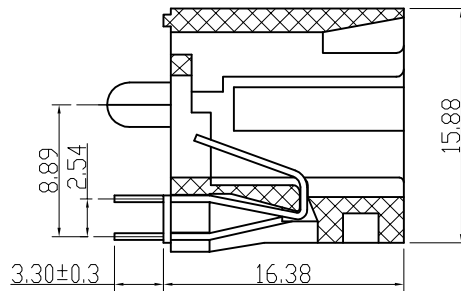
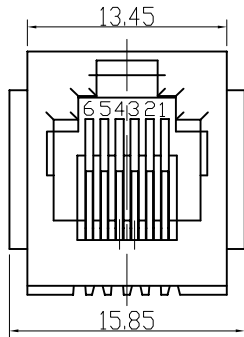

电气特性:

1. 额定电压: 150 VAC RMS
2. 额定电流: 1.5 AMPS@25° C
3. 接触电阻: 20m Ω MAX.
4. 绝缘电阻: 1000 M Ω MIN. @500 VDC
5. 耐压强度: : CONTACT TO CONTACT : 1000V DC OR AC PEAK;
: CONTACT TO SCREEN AND TEST PANEL : 1500V DC OR AC PEAK
@0.5mA 50Hz 或 60Hz 一分钟.

ENVIRONMENTAL:

1. STORAGE TEMPERATURE : -40°C~+85°C RELATIVE HUM DITY<80%
 2. OPERATION TEMPERATURE : -40°C~+85°C
- MATES WITH MODULAR PLUG CONFORMING TO FCC PART 68, SUBPART F.
ROHS PART NUMBER:

NOTES:

ELECTRICAL:

1. VOLTAGE RATING : 150 VAC RMS.
2. CURRENT RATING : 1.5 AMPS@25° C
3. CONTACT RESISTANCE : 20 m Ω MAX.
4. INSULATION RESISTANCE : 1000 M Ω MIN @500VDC.
5. WITHSTAND VOLTAGE : CONTACT TO CONTACT : 1000V DC OR AC PEAK;
: CONTACT TO SCREEN AND TEST PANEL : 1500V DC OR AC PEAK
@0.5mA 50Hz OR 60Hz a minute.

MECHANICAL:

1. HOUSING & INSERT MATERIAL : PBT UL94V-0.
2. CONTACT MATERIAL : PHOSPHOR BRONZE $\varnothing 0.46\text{mm}$
3. CONTACT PLATING : GOLD PLATING OVER NICKEL.
4. MENTAL PEG : BRASS T=0.5mm PLATED NICKEL.
5. MATING/UNMATING FORCE: : 30N Max. .
6. RETENTION STRENGTH : 50N for 60s \pm 5s.
7. DURABILITY : 750 CYCLES MN.

ROHS PART NUMBER:

NEW P/N 料号	P/N 料号	DESCRIPTION	LOGO	MATERIAL COLOR
	B522N-6215-M007	RJ11 5222 6P2C(34) (MON PEG)/5222插座6P2C 15u"(有耳L脚有网)	NO LOGO	PBT GRAY灰
	B522N-6203-MD23	RJ11 5222 6P2C(34) (MON PEG)/5222插座6P2C 3u"(有耳L脚有网)	NO LOGO	PBT GRAY灰
	B522N-626F-MD23	RJ11 5222 6P2C(34) (MON PEG)/5222插座6P2CG/F(有耳L脚有网)	NO LOGO	PBT GRAY灰
10201662A008	B522N-626F-MD25	RJ11 5222 6P2C(34) (MON PEG)/5222插座6P2CG/F(有耳L脚有网)	NO LOGO	PBT BLACK黑
10201664A013	B522N-64GF-MD27	RJ11 5222 6P4C(2345) (MON PEG)/5222插座6P4CG/F(有耳L脚有网)	NO LOGO	PBT BLACK黑
10201666A009	B522N-66GF-MD19	RJ11 5222 6P6C (MON PEG)/5222插座6P6CG/F(有耳L脚有网)	NO LOGO	PBT BLACK黑
	B522N-6650-MD19	RJ11 5222 6P6C (MON PEG)/5222插座6P6C 50u"(有耳L脚有网)	NO LOGO	PBT BLACK黑
10201664B009	B522N-6403-MD27	RJ11 5222 6P4C(2345) (MON PEG)/5222插座6P4C 3u"(有耳L脚有网)	NO LOGO	PBT BLACK黑
	B522N-6203-MD04	RJ11 5222 6P2C(34) (MON PEG)/5222插座6P2C 3u"(有耳L脚有网)	NO LOGO	PBT BLACK黑
10201666B006	B522N-6603-MD19	RJ11 5222 6P6C (MON PEG)/5222插座6P6C3u"(有耳L脚有网)	NO LOGO	PBT BLACK黑
10201662C009	B522N-6206-MD25	RJ11 5222 6P2C(34) (MON PEG)/5222插座6P2C 6u"(有耳L脚有网)	NO LOGO	GOLD GREY 432C冷灰
10201666C010	B522N-6606-MD19	RJ11 5222 6P6C (MON PEG)/5222插座6P6C 6u"(有耳L脚有网)	NO LOGO	PBT BLACK黑
10201666D001	B522N-6615-MD19	RJ11 5222 6P6C (MON PEG)/5222插座6P6C 15u"(有耳L脚有网)	NO LOGO	PBT BLACK黑

RoHS Compliant

5222 6P 有耳 L脚 有网插座

CZT ® 温州惠华接插件股份有限公司 WENZHOU YIHUA CONNECTOR CO., LTD		TOLERANCES 公差 00~15 \pm 0.15 15~30 \pm 0.20 30~ \pm 0.25 ANGLES \pm 1°	Material: 材质 SEE_NOTE	Designed: 设计 陈智艳	NAME: 名称 RJ11 5222 6P (MON PEG) JACK
第一视角	SCALE 比例 1:1	UNIT 单位 mm	Finish: 电镀 SEE_NOTE	Checked: 审核	DWG NO: 图号 E52QWY-1006-8
	CUSTOMER: 客户 MODEL NO: 料号		SHEET 1 OF 1 第 页 共 页	Approved: 核准	PART NO: 料号 SEE_NOTE